

The Artium User Manual



Power of OGI SYSTEMS Ltd.

Other detectors models of OGI Systems



DiaTrue Mobile



DiaTrue CS



DiaTrue CX



DiaTrue CXL



Galileo



Artium



DiaTrue Jumbo

We have couple of detectors models that work under two platform operating systems , Windows or Android.

Diatrue CS, CX, CXL, Jumbo working under windows .

Galileo, Mobile, Artium working under android (cell phone).

Diatrue - www.diatrue.com

Galileo - www.Galileotester.com

Artium - www.Artiumtester.com

INTRODUCTION

The **Artium** detector detects lab grown Diamonds, mounted in Jewelry, as single stones, in large parcels and any size Melee.

The main purpose of the device is to detect **CVD** and **HPHT** lab grown diamonds, but it can be also used to detect diamond simulants - CZ and Moissanite, diamond coated CZ and Moissanite.

The **Artium** detector is designed to detect only white diamonds within D - K colors but we have few models that can detect even lower from K. We suggest lower color diamonds, fancy color diamonds, or any other gemstones should not be tested to avoid mistakes.

If in any case they are tested, keep in mind that the result will be misleading and false.

For accurate testing, we prefer that you not use plastic bags.

To update your device to the latest software/app visit the website of your specific device.

www.diatrue.com

www.galileotester.com

www.artiumtester.com

ARTIUM PACKAGE INCLUDE

Artium device

Matrix Stone Tray

Loose Stone Tray

Rings/ Earrings / Jewelry Tray

360 Ring holder x 2 (two different size)

360 Bracelet holder x 2 (two different size)

360 Earring holder

User manual book

Warranty card

Power supply

AC power cable



360° Ring holders
(two different size)

360° Bracelet holders
(two different size)

360° Earring
holder

CHECKING STONES

The way how the effect of the light on diamond.

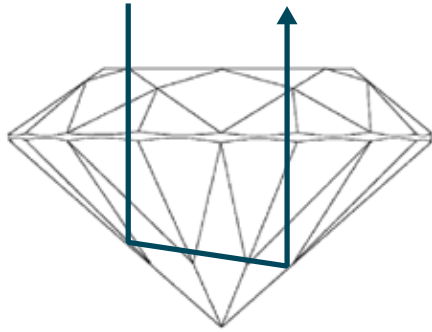

The light of the Artium camera comes from the top for testing loose diamonds we recommend to position the stone on the **pavilion side**. **Example** Pavilion face.



Table face



Pavilion face

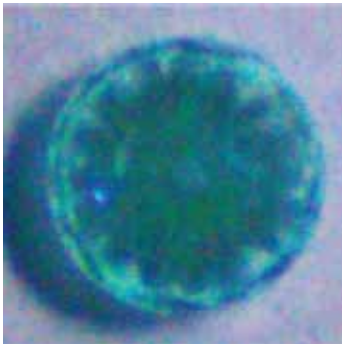

OPERATION

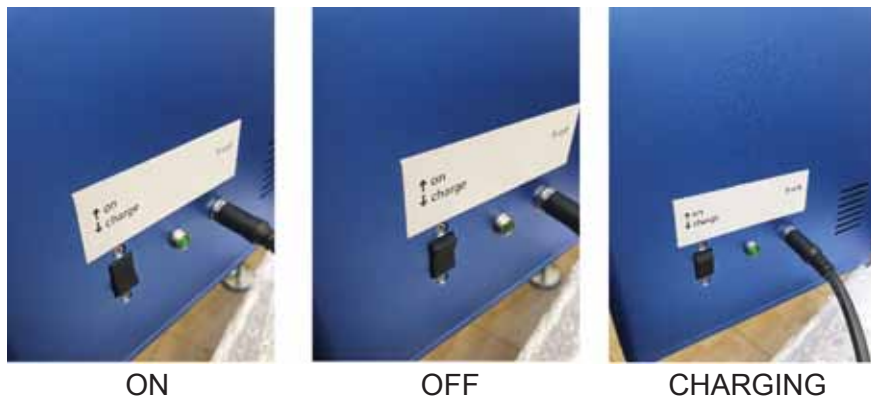

The charger can work in any voltage environment (100V-240V) output is 9 Volt.

But each device has personal power supply and different input voltage. **(Please don't use other power supply)**
(User can purchase a rechargeable battery)

The charger must be connected when working with the detector.

Back button has 3 options. ON-OFF-CHARGING

Option 1 is ON - push the button up.

Option 2 is OFF - push the button to the middle stage.

Option 3 is CHARGING - push the button down.

To start please press ON and the light indicator turn on too.

HOW ARTIUM WORK



Open the drawer and put the stones in the tray.

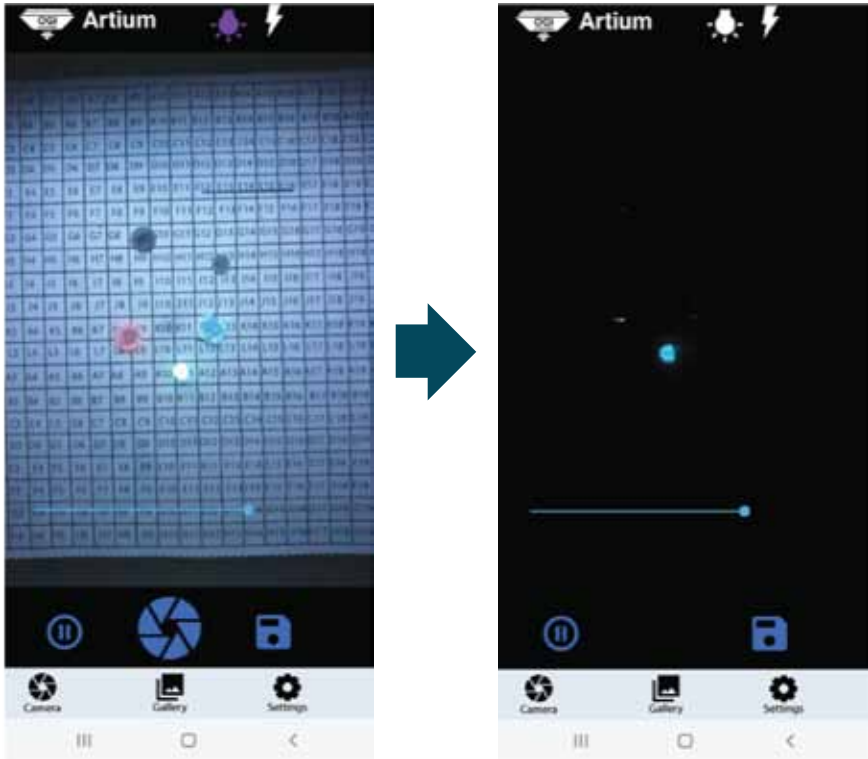

FAST MODE CHECKING

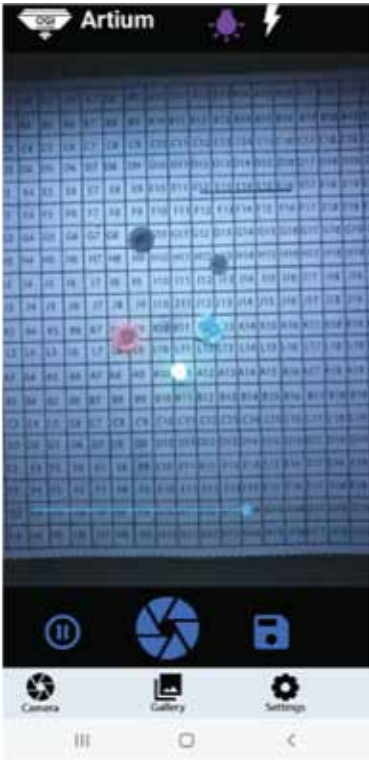

Click on **UV** lamp and wait until the UV come ON (it can take a few seconds). For a fast result, if you click again on UV lamp then the UV come OFF and all phosphoresces stones come highlight (This option is good to see if parcel has HPHT lab grown stones) but we recommend always to do a full scan.

AUTO FULL SCAN



Click on UV lamp  and wait when it turn ON .

Press on the  and full scan process starting.

At the end of the full scan process you will get the result and 4 small windows.

Filtered - window show the HPHT lab grown in **RED** color.

HPHT - window can see only the HPHT lab grown stone.

UV - window will see the UV results only.

Source - window will see the original white light.





Press on any window it will come large on the screen.
Every scan will be automatically saved in the gallery.

Press on CAMERA to start the process again

Press on CAPTURE  , it saves a print screen of the opened large screen in your gallery.

SHARING, REFERENCE, MENU



On top screen you have  (sharing),  stones reference feature and  (menu)

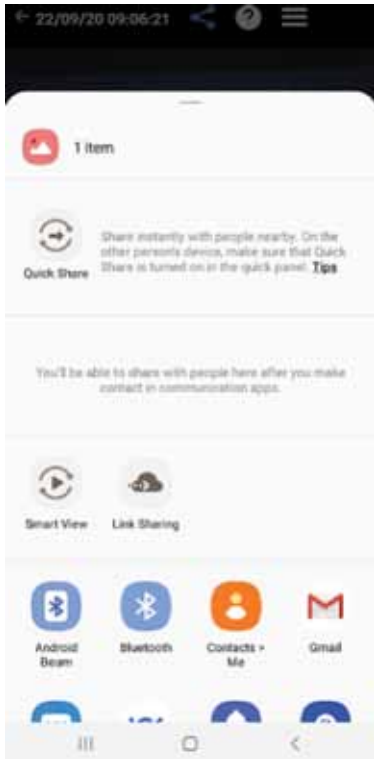

With **SHARE** feature you can send the report or any results by E-mail or print to WIFI printer.

COLOR REFERENCE HELP



Click on  icon you will get **color reference help**.

What MENU include

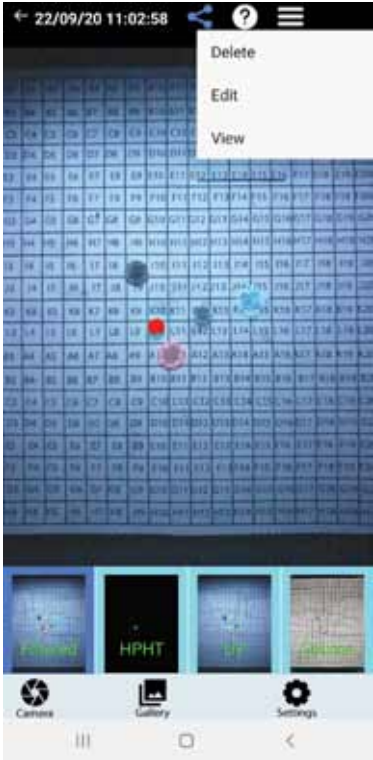

With this menu you are able to edit or delete a report.

A DECISION WITHOUT A DOUBT



Edit stones quantity and total weight

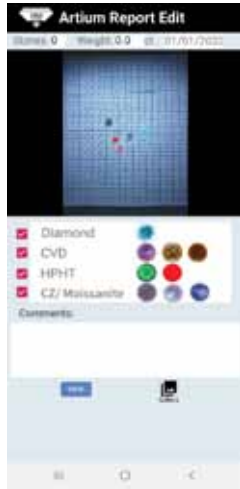

Click VIEW to get the final report

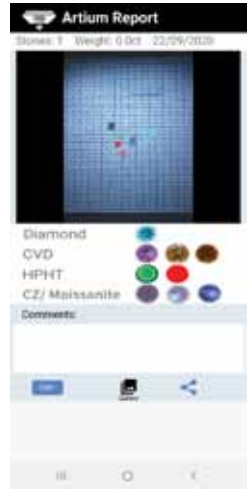

Can share the report or print it

GALLERY

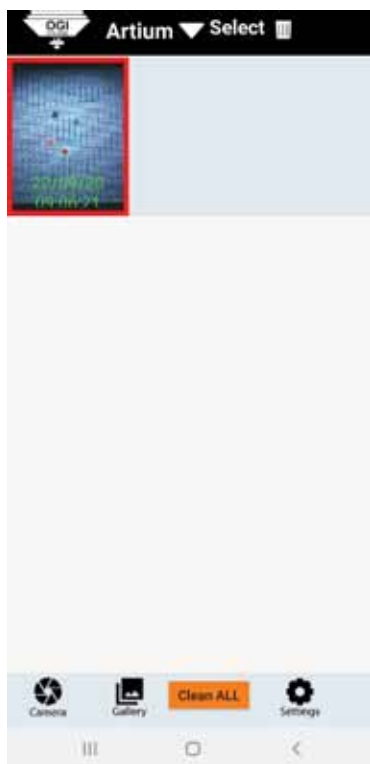
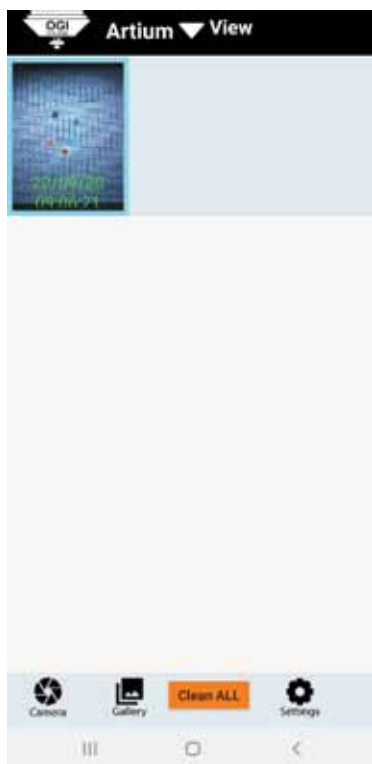

View can load the result to the main screen.

Select and click on the results that you want to delete and then click the *trash icon*.

How to scan RINGS



Artium has feature to able to scan 360 around the rings.
Please insert the ring holder to the correct place and close
the drawer.



Fast mode



Fast mode



Auto scan

Scanning rings is the same way as scanning stones.

Fast mode – Turn ON the UV lamp and rotate slowly the rings holder 360 degree to see in many angles view.

Auto Scan – In any positions you can click auto scan to get 4 small windows like stones scanning process.

How to scan BRACELETS



Artium has feature to able to scan 360 around the bracelets.
Please insert the bracelet holder to the correct place and close the drawer.



Fast mode



Fast mode

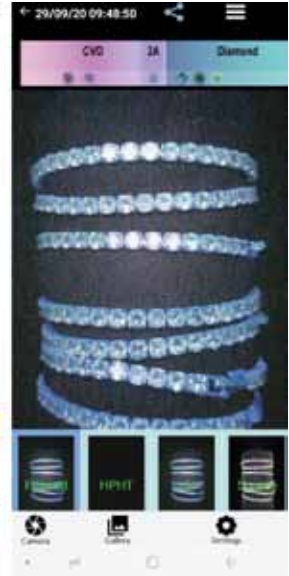

Auto scan

Scanning bracelets is the same way as scanning stones.

Fast mode – Turn ON the UV lamp and rotate slowly the bracelets holder 360 degree to see in many angles view.

Auto Scan – In any positions you can click auto scan to get 4 small windows like stones scanning process.

How to scan EARRINGS



Artium has feature to able to scan 360 around the earrings.
Please insert the earring holder to the correct place and close the drawer.



Fast mode

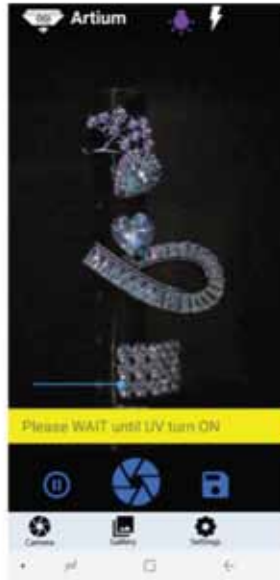

Fast mode



Auto scan

Scanning earrings is the same way as scanning stones.

Fast mode – Turn ON the UV lamp and rotate slowly the earrings holder 360 degree to see in many angles view.

Auto Scan – In any positions you can click auto scan to get 4 small windows like stones scanning process.

SETTING



User can control how many minutes the UV needs to be on when he uses real time mode

Natural diamonds example results

Any diamond that shines ONLY blue or light blue colors mean it's natural.

some diamonds were the clarity (black carbon inside diamond) is very bad like SI2, cleavage, coated or with brown touch color it can mix with green color but for this kind of color need to make more testing.

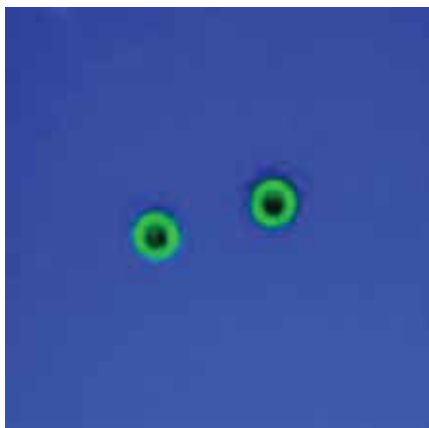

Device detect D to K but some stones lower than K or lower clarity or irregular internal material then it come green color in circle edge.



A1 if reduce the light it can see very clearly like C1.

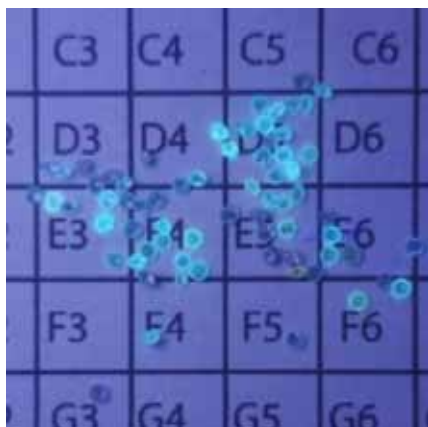
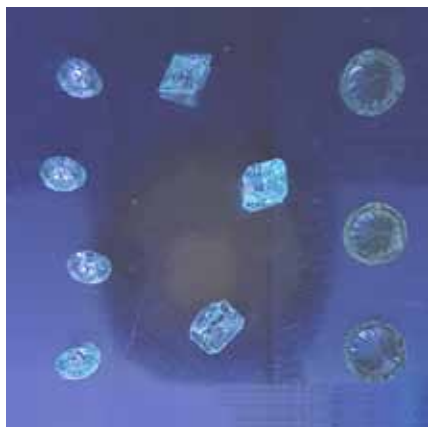

LAB GROWN diamonds result examples

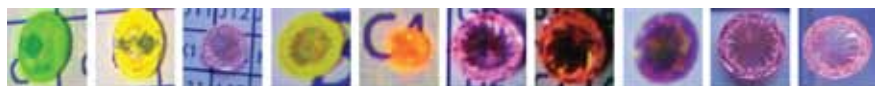
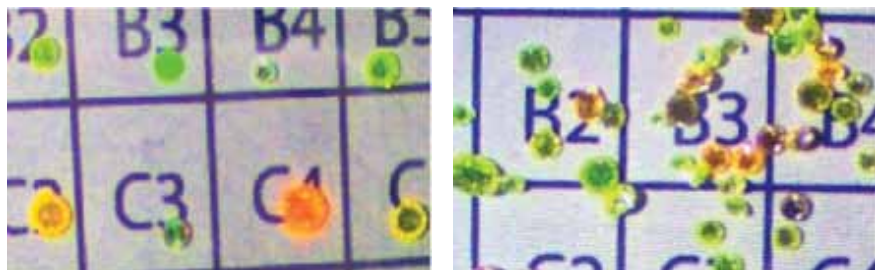

Diamonds SIMULANTS example results



JEWELRY EXAMPLE RESULTS



CZ



Try to reduce the light to get a correct color and if the stone is not blue then send the stone to the lab.



CZ



Diamonds setting



Red is **HPHT** lab grown

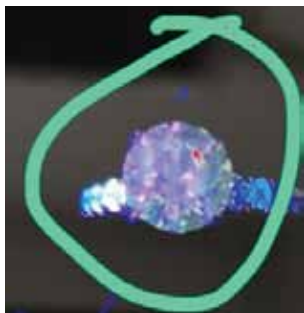

Big stone is **CVD**



CVD



Big stone is **CVD**

This picture show how important it is to able to rotate the ring to expose the ring to UV light in few different angles.

Disclaimer, exclusions, and limitation of liability

Please read and read the terms and conditions of OGI Systems' warranty.

OGI Systems Warranty for Subject to Proper Use by Its Users. In accordance with all the terms and conditions as stated in the relevant user guide.

Due to the continued improvement of the product, OGI Systems reserves the right to change all documents including the right to make changes to the user manual without prior notice and without obligation to notify any person of such corrections or changes.

The material in this guide is for informational purposes only. The products he describes may change without notice and without obligation, due to the manufacturer's continuous development plan.

OGI makes no representations or warranties with respect to this manual or with respect to the products described herein.

OGI will not be liable for any damage, loss, cost or expense, direct, indirect or incidental, consequential or special, arising out of or related to the use of this material or the products described therein. OGI does not take any responsibility for any inaccuracies or errors in the results or the device under any conditions.

The OGI detectors like models CS, CX, CXL, Jumbo, Mobile, Artium, Galileo are not a substitute for gemological laboratory analysis but can provides a convenient and quick method of detecting synthetic diamonds. Inaccurate results may be caused by new synthetic diamonds are created in new technology, or many inclusions inside stones or other errors. OGI detectors results should be treated as informational only and the results are provided "as is", with no guarantee of completeness or accuracy.

OGI detectors are provided without warranty of any kind, express or implied, including, but not limited to warranties of performance, merchantability and fitness for a particular purpose. In no event will the Company, its related entities, or their respective stockholders, officers, directors, agents, subsidiaries, licensors, distributors, resellers, or employees be liable to you or anyone else for any decision made or action taken in reliance on the information provided by OGI detectors, or for any consequential, special or similar damages, even if advised of the possibility of such damages.

Again for the avoidance of doubt the company shall not be responsible for any damage or loss resulting from the use of the product or user manual, and under no circumstances shall Company, its manufacturer or any of its subsidiaries, licensors, distributors, resellers, servants and/or agents be liable for any direct or indirect damages resulting from the use of this product.

Troubleshooting:

3 options of the back button



ON



OFF



CHARGING

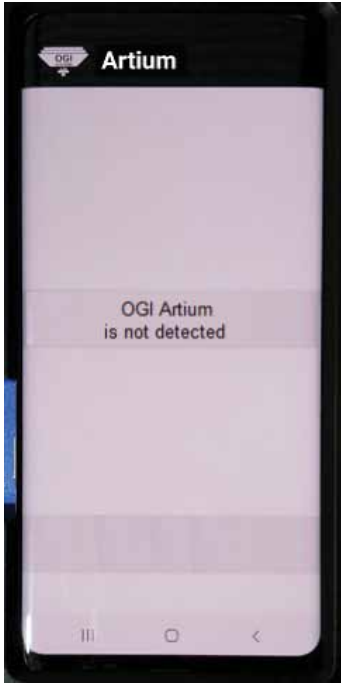

Make sure the button ON for regular operation.

Button down for charging the cell phone.

Warranty:

The detector has a 1 year full warranty under normal use.
It does not cover water damages, being hit, dropped or any other.
The machine has protective warranty stickers.
Opening or tampering with any of the screws or trying to open the detector body will also result in a loss in warranty.

For further information, please log-on to:
www.artiumtester.com

Telephones:

Israel : +972-3-5758720
USA : +1 212 244 4455
Belgium : +32 32274868
Bangkok : +66 931257741
India : +91 9820211325
Italy : +39 0462 342662
Hong Kong : +852 69188584
China : +86 186 65602904

©All Rights Reserved to OGI Systems Ltd 2020.

No part of this publication may be reproduced, distributed, or transmitted in any form or by any means, including photocopying, recording, or other electronic or mechanical methods, without the prior written permission of the owner, except in the case of brief quotations embodied in critical reviews and certain other noncommercial uses permitted by copyright law. For permission requests, contact to the owner (OGI Systems Ltd.), at the address below.

OGI SYSTEMS LTD
34 TUVAL ST. RAMAT-GAN 5252244
ISRAEL
TEL: + 972-3-5758720

WhatsApp [dani@ogisystems.com](https://api.whatsapp.com/send?phone=97235758720)
Email: office@ogisystems.com
Email: daicothai@gmail.com
WWW.OGISYSTEMS.COM

